

FK.229

Lumenition

OPTRONIC[®] IGNITION

INFRA-RED SOLID STATE BREAKERLESS IGNITION SYSTEM.

90220

A BRITISH INVENTION

Lumenition

Division of **Autocar** Equipment Ltd

77-85 NEWINGTON CAUSEWAY

LONDON SE1 6BJ. ENGLAND

Patent Nos. 1219833, 1252324, 1252559, 1279385, 1330453,

1410782, 1417857, 1420814, 1437770.

® Registered Trade Mark.

FITTING INSTRUCTIONS

BOSCH NON-VACUUM DISTRIBUTORS.

6 CYLINDER CLOCK.

4 CYLINDER CLOCK AND ANTI-CLOCK.

(Not for top bearing type distributors)

Disconnect: *Battery Negative Terminal.*

Remove:	Distributor Cap	(9)
	Rotor	(1)
	Dust Cap (if fitted)	(10)
	Contact Breaker	(5)
	Condenser with Grommet	(8)

Check: Mechanical advance operation

INSTALLATION OF OPTICAL SWITCH

- 1 Assemble adaptor plate (6) supplied, into distributor by locating the pip on the plate into large hole in distributor base plate. Secure into position using countersunk screw.(26) fitted into original contact breaker fixing hole.
- 2 Fit optical switch (4) to adaptor plate (6) using screws (11) and washers (12) supplied.
- 3 Feed the optical switch wires out through distributor body exit hole/slot using shortest practical route.
- 4 Select correct grommet to fit distributor exit hole/slot.
- 5 Slide selected grommet (3) over the optical switch wires and locate into distributor body exit hole/slot.

WIRE INSULATION MUST NOT BE DAMAGED.

(note: on certain distributors with a small wire exit hole it may be easier to fit grommet into exit hole before feeding wires through).

- 6 Select correct chopper (2) for distributor: **FOUR CYLINDER** (four bladed chopper), fit chopper over cam ensuring cam peaks locate in wide gap between chopper bore ribs. **SIX CYLINDER** (six bladed chopper), fit chopper over cam ensuring cam peaks locate in unfilled gap between chopper bore ribs. (Where two choppers are supplied with an equal number of blades, select tightest fitting). Ensure chopper is pushed fully down.
- 7 Check that there is sufficient wire length between optical switch (4) and grommet (3). **ENSURE THAT THE WIRES ARE ROUTED CLEAR OF ROTATING CHOPPER BLADES.**
- 8 For the fitting of optical switch wires into connector (13) (and subsequent removal if desired), see fitting instruction supplied with power module/optical switch. **DO NOT CUT THE WIRES.**
- 9 Re-fit the rotor (1) and distributor cap (9).
- 10 Reconnect the battery negative terminal and check ignition timing to manufacturers specification when complete system is fitted.

FK.229

**Bosch 6-Cylinder Distributors
Clockwise Rotation
(Without Vacuum Advance)**

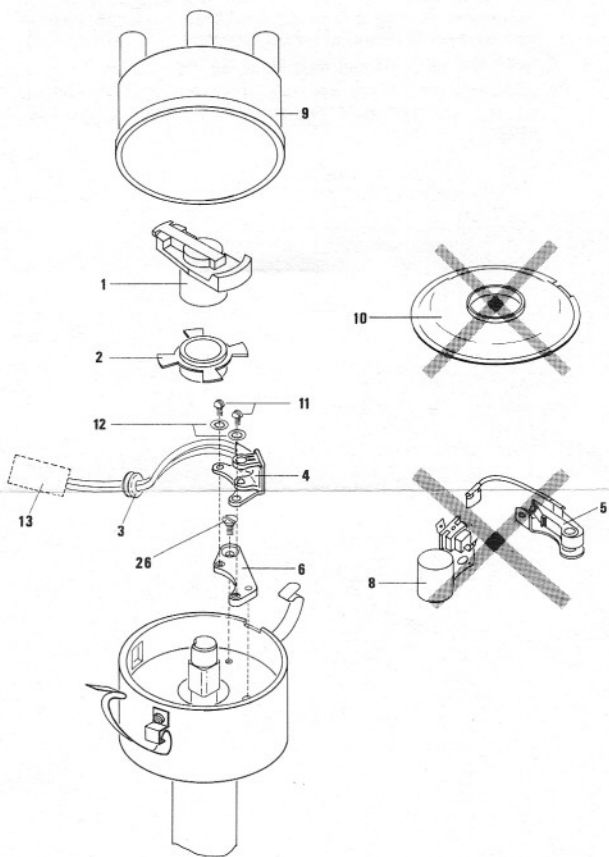

FOUR CYLINDER, BOSCH.

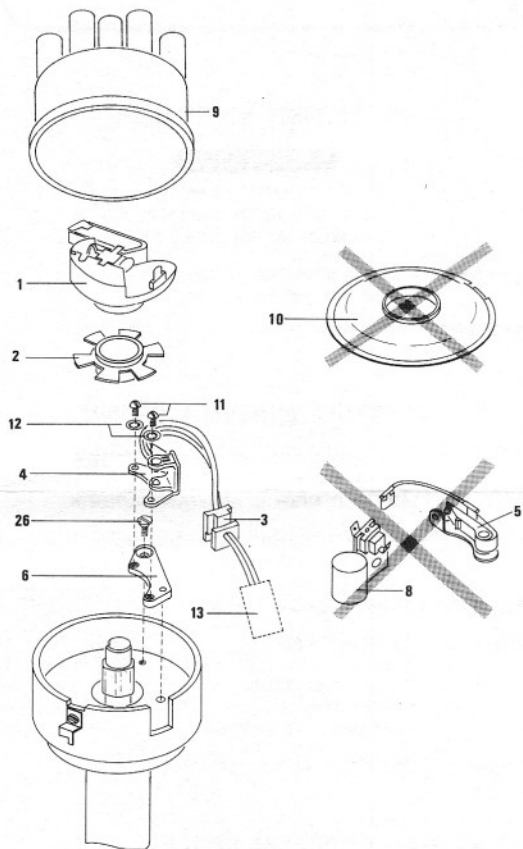

SIX CYLINDER, BOSCH.